

# BLUE NINE TREE MANAGEMENT PROJECT

160 COUNTRY CLUB ROAD

PREPARED FOR

## GOLF CLUB OF AVON

160 COUNTRY CLUB ROAD  
AVON, CT

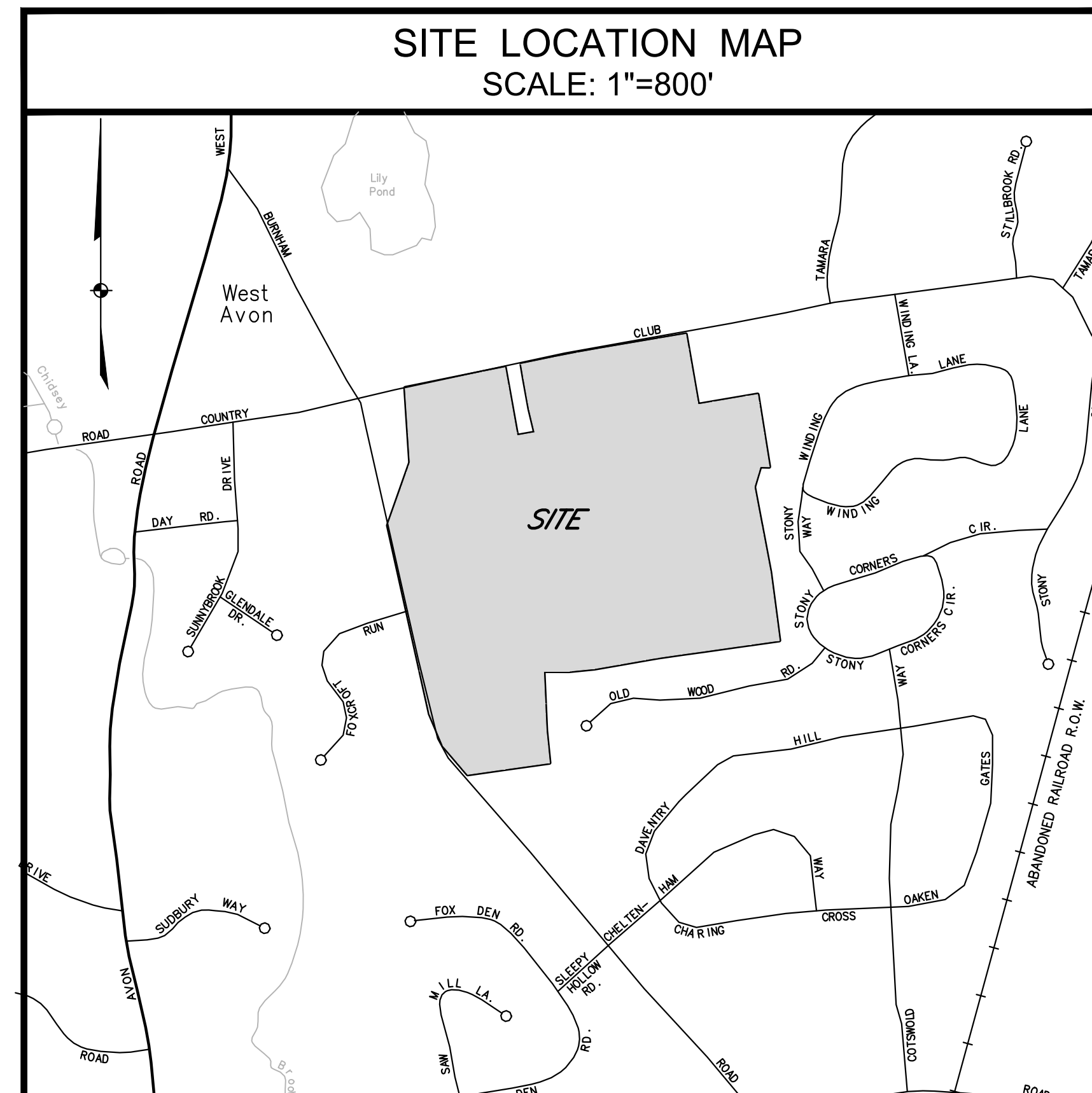

FEBRUARY 10, 2021

GHA PROJECT #21-001



PROFESSIONAL LAND SURVEYORS & CIVIL ENGINEERS  
26 BROADWAY NORTH HAVEN, CT 06473; TEL: 203.239.4217 - WWW.GODFREYHOFFMAN.COM  
1783 FARMINGTON AVENUE, UNIONVILLE, CT 06085; TEL: 860.673.0444 - WWW.HODGELLCC.COM

FOR REVIEW ONLY



**GENERAL NOTES**

1. TOPOGRAPHICAL, PROPERTY LINES, EXISTING SITE FEATURES, AND UTILITY INFORMATION TAKEN FROM MAPS PREPARED BY GODFREY-HOFFMAN HODGE, LLC. INFORMATION ON EXISTING UTILITIES HAS BEEN COMPILED FROM AVAILABLE INFORMATION INCLUDING UTILITY COMPANY AND MUNICIPAL RECORD MAPS AND FIELD SURVEY AND IS NOT GUARANTEED CORRECT OR COMPLETE. UTILITIES ARE SHOWN TO ALERT THE CONTRACTOR TO THEIR PRESENCE. THE CONTRACTOR AND/OR RESPONSIBLE PARTY IS SOLELY RESPONSIBLE FOR DETERMINING ACTUAL LOCATIONS AND ELEVATIONS OF ALL UTILITIES INCLUDING SERVICES. PRIOR TO CONSTRUCTION, CONTACT "CALL BEFORE YOU DIG" AT 800-922-4455 AND VERIFY ALL UNDERGROUND AND OVERHEAD UTILITY LOCATIONS.
2. IT IS THE RESPONSIBILITY OF THE CONTRACTOR TO VERIFY ALL ELEVATIONS, PROPERTY LINES, LOCATION OF UTILITIES AND SITE CONDITIONS IN THE FIELD. IF AN UNFORESEEN INTERFERENCE EXISTS BETWEEN AN EXISTING AND A PROPOSED STRUCTURE, THE CONTRACTOR SHALL NOTIFY THE DESIGN ENGINEER SO THAT THE APPROPRIATE REVISIONS CAN BE MADE.
3. IT IS THE DEVELOPER'S RESPONSIBILITY TO OBTAIN ALL NECESSARY PERMITS AND/OR EASEMENTS FROM STATE AND LOCAL AUTHORITIES AND ANY CONSTRUCTION RIGHTS AND/OR SLOPE RIGHTS AS MAY BE REQUIRED FROM THE PROPERTY OWNERS.
4. THE CONTRACTOR IS TO CONTACT "CALL BEFORE YOU DIG" TO HAVE ALL UTILITY LINES CLEARLY MARKED PRIOR TO ANY EXCAVATION.
5. IT IS THE RESPONSIBILITY OF EACH BIDDER IN EVALUATING THESE PLANS TO MAKE EXAMINATIONS IN THE FIELD BY VARIOUS METHODS AND OBTAIN NECESSARY INFORMATION FROM AVAILABLE RECORDS, UTILITY CORPORATIONS, AND INDIVIDUALS AS TO THE LOCATION OF ALL SUBSURFACE STRUCTURES.
6. THE CONTRACTOR IS TO USE CAUTION WHEN WORKING NEAR OR UNDER OVERHEAD AND UNDERGROUND UTILITIES. THE CONTRACTOR IS TO NOTIFY THE UTILITY COMPANIES OF HIS INTENT PRIOR TO THE COMMENCEMENT OF ANY WORK.
7. ALL CONSTRUCTION SHALL BE IN ACCORDANCE WITH THE TOWN OF AVON STANDARDS.
8. ANY DRAINAGE STRUCTURES, DITCHES, ASPHALT, CURBS OR GRASSED AREAS DISTURBED DURING CONSTRUCTION SHALL BE RESTORED TO THE ORIGINAL CONDITION.
9. ALL AREAS OF DISTURBED EARTH SHALL BE STABILIZED BY MULCHING OR OTHER MEANS. SEEDING OF GRASSED AREAS SHALL BE INITIATED AS SOON AS PRACTICAL AS AN EROSION AND SILTATION CONTROL MEASURE.
10. ANY WORK AFFECTING EXISTING TREES WITHIN A CITY ROAD RIGHT-OF-WAY OR ON CITY PROPERTY IS TO BE APPROVED BY THE TOWN OF AVON.

**MAP REFERENCE:**

PROPERTY LINE AND EXISTING CONDITIONS INFORMATION OBTAINED FROM MAP PREPARED BY GODFREY-HOFFMAN HODGE, LLC, 26 BROADWAY NORTH HAVEN, CT 06473, ENTITLED "COMPILED PLAN PREPARED FOR GOLF CLUB OF AVON, 160 COUNTRY CLUB ROAD, AVON, CONNECTICUT", DATED 01-13-2021.

**SEQUENCE OF OPERATIONS:**

1. FLAG THE 100' UPLAND REVIEW AREA FROM WETLANDS.
2. FLAG LIMITS OF TREE REMOVAL AND CONSTRUCTION, ADJUST LIMITS IF AREAS WITHIN THE 100' UPLAND REVIEW AREA ARE ENCLOSED UPON. SCHEDULE PRE-CONSTRUCTION MEETING WITH REPRESENTATIVES OF THE OWNER, CONTRACTOR, ENGINEER AND LOCAL AUTHORITY.
3. HOLD PRE-CONSTRUCTION MEETING PRIOR TO ANY SITE DISTURBANCE. REVIEW EROSION CONTROL PLAN AND DISCUSS SCHEDULING OF SITE INSPECTIONS DURING CONSTRUCTION ACTIVITIES.
4. IDENTIFY TREES TO REMAIN AND INSTALL TREE PROTECTION.
5. INSTALL CONSTRUCTION ENTRANCE.
6. INSTALL PERIMETER EROSION AND SEDIMENTATION CONTROLS IN ACCORDANCE WITH THE E&S CONTROL PLAN.
7. BEGIN TREE CUTTING AND STUMP REMOVAL. TREES AND STUMPS SHALL BE REMOVED FROM THE SITE.
8. UPON COMPLETION OF STUMP REMOVAL, RE-ESTABLISH EXISTING GRADES AND PLACE TOPSOIL WHERE REQUIRED.
9. INSTALL SEED AND APPLY MULCH FOR TEMPORARY STABILIZATION.
10. AFTER SITE IS STABILIZED REMOVE TEMPORARY EROSION AND SEDIMENT CONTROLS.



**IMPORTANT NOTE:**  
 ADDITIONAL UNDERGROUND UTILITIES MAY EXIST.  
 PRIOR TO ANY EXCAVATION OR CONSTRUCTION,  
 CONTACT:  
 "CALL BEFORE YOU DIG" 1-800-922-4455

**GODFREY-HOFFMAN HODGE, LLC**  
 PROFESSIONAL ENGINEERS  
 26 BROADWAY NORTH HAVEN, CT 06473 TEL: 203.209.4271 WWW.GODFREYHOFFMAN.COM  
 1783 FARMINGTON AVENUE, UNIONVILLE, CT 06896 TEL: 860.673.0444 - WWW.HODGELL.COM

**FOR REVIEW ONLY**  
 NOT VALID WITHOUT THE SIGNATURE AND SEAL

ALL WORK, MATERIALS, AND METHODS TO BE IN ACCORDANCE WITH THE LATEST EDITIONS OF THE SPECIFICATIONS AND STANDARDS OF THE PROFESSION OF CIVIL ENGINEERS. THE INFORMATION CONTAINED HEREIN IS THE PROPERTY OF GODFREY-HOFFMAN HODGE, LLC. NO REPRODUCTION, IN WHOLE OR IN PART, OR TRANSMISSION IN ANY FORM OR BY ANY MEANS, ELECTRONIC OR MECHANICAL, INCLUDING PHOTOCOPYING, RECORDING, OR BY ANY INFORMATION STORAGE AND RETRIEVAL SYSTEM, IS PERMITTED WITHOUT THE WRITTEN PERMISSION OF GODFREY-HOFFMAN HODGE, LLC. © COPYRIGHT 2020. ALL RIGHTS RESERVED.

REVISION SCHEDULE	
NO.	DESCRIPTION

**PROJECT:**  
**BLUE NINE TREE MANAGEMENT**  
 160 COUNTRY CLUB ROAD  
 AVON, CT

**PREPARED FOR:**  
**GOLF CLUB OF AVON**  
 160 COUNTRY CLUB ROAD  
 AVON, CT

**SHEET INDEX PLAN AND NOTES**

**DRAWN BY:** JR  
**CHECKED BY:** JR  
**SCALE:** 1"=200'  
**PROJECT:** 21-001  
**DATE:** 02.10.2021

**C-1.0**

REFER TO DRAWING NO. C-7.0 FOR EROSION AND SEDIMENTATION CONTROL DETAILS AND NOTES.

MATCH LINE C-3.0



MATCH LINE C-4.0

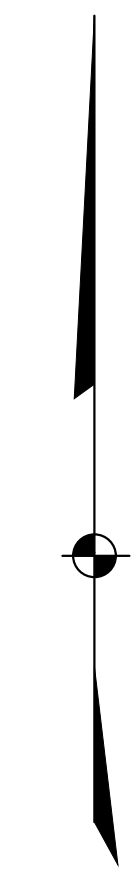

**IMPORTANT NOTE:**  
 ADDITIONAL UNDERGROUND UTILITIES MAY EXIST.  
 PRIOR TO ANY EXCAVATION OR CONSTRUCTION,  
 CONTACT:  
 "CALL BEFORE YOU DIG" 1-800-922-4455

**FOR REVIEW ONLY**

ALL WORK, PERMITS, AND MATERIALS TO BE IN STRICT ACCORDANCE WITH THE LATEST EDITIONS OF THE SPECIFICATIONS AND STANDARDS OF PRACTICE FOR THE PROFESSION OF LANDSCAPE ARCHITECTURE. THE WORD "SHOULD" OR "MAY" IS UNDERSTOOD TO BE A RECOMMENDATION OR SUGGESTION, WHICH IS NOT TO BE CONSIDERED A GUARANTEE OR WARRANTY. THE INFORMATION CONTAINED HEREIN IS THE PROPRIETARY AND CONFIDENTIAL INFORMATION OF GODFREY & HOFFMAN HODGE, LLC. NO REPRODUCTION, IN WHOLE OR IN PART, OR TRANSMISSION IN ANY FORM OR BY ANY MEANS, ELECTRONIC OR MECHANICAL, INCLUDING PHOTOCOPYING, RECORDING, OR BY ANY INFORMATION STORAGE AND RETRIEVAL SYSTEM, IS PERMITTED WITHOUT THE WRITTEN PERMISSION OF GODFREY & HOFFMAN HODGE, LLC. THIS DOCUMENT IS THE PROPERTY OF GODFREY & HOFFMAN HODGE, LLC. IT IS TO BE USED ONLY FOR THE PROJECT AND SITE SPECIFICALLY IDENTIFIED HEREIN. ALL RIGHTS RESERVED. © COPYRIGHT 2020. ALL RIGHTS RESERVED.

NO.	DATE	REVISION SCHEDULE	DESCRIPTION

PROJECT:  
**BLUE NINE TREE MANAGEMENT**  
 160 COUNTRY CLUB ROAD AVON, CT

PREPARED FOR:  
**GOLF CLUB OF AVON**  
 160 COUNTRY CLUB ROAD AVON, CT

**TREE MANAGEMENT PLAN**

DRAWN BY: JR  
 CHECKED BY: JR  
 SCALE: 1"=60'  
 PROJECT: 21-001  
 DATE: 02.10.2021

**C-2.0**

**GODFREY & HOFFMAN HODGE, LLC**  
 PROFESSIONAL LANDSCAPE ARCHITECTS  
 26 BROADWAY NORTH HAVEN, CT 06472 TEL: 203.239.4217 WWW.GODFREYHOFFMAN.COM  
 1783 FARMINGTON AVENUE, UNIONVILLE, CT 06886 TEL: 860.673.0444 WWW.HODGELL.COM

REFER TO DRAWING NO. C-7.0 FOR EROSION AND SEDIMENTATION CONTROL DETAILS AND NOTES.



MATCH LINE C-5.0

MATCH LINE C-2.0

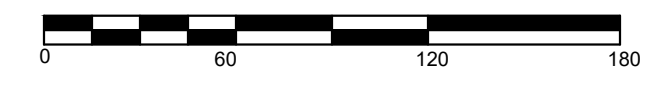

IMPORTANT NOTE:  
 ADDITIONAL UNDERGROUND UTILITIES MAY EXIST.  
 PRIOR TO ANY EXCAVATION OR CONSTRUCTION,  
 CONTACT:  
 "CALL BEFORE YOU DIG" 1-800-922-4455

**GODFREY & HOFFMAN**  
**HODGE, LLC**  
 PROFESSIONAL LAND SURVEYORS AND ENGINEERS  
 26 BROADWAY, NORTH AVENUE, CT 06173 TEL: 203.298.4217 WWW.GODFREYHOFFMAN.COM  
 1783 FARMINGTON AVENUE, UNIONVILLE, CT 06885 TEL: 860.673.0444 WWW.HODGELL.COM

**FOR REVIEW ONLY**  
 NOT VALID WITHOUT THE SIGNATURE AND SEAL

ALL WORK, PERMITS, AND MATERIALS TO BE IN STRICT ACCORDANCE WITH THE LATEST EDITIONS OF THE STATE OF CONNECTICUT'S REGULATIONS IN THE FIELD OF PROFESSIONAL ENGINEERING AND SURVEYING. THE USER'S RESPONSIBILITY IS TO VERIFY THE ACCURACY OF THE INFORMATION PROVIDED HEREIN. THE INFORMATION CONTAINED HEREIN IS THE PROPERTY OF GODFREY & HOFFMAN HODGE, LLC. NO REPRODUCTION, IN WHOLE OR IN PART, OR TRANSMISSION IN ANY FORM OR BY ANY MEANS, ELECTRONIC OR MECHANICAL, INCLUDING PHOTOCOPYING, RECORDING, OR BY ANY INFORMATION STORAGE AND RETRIEVAL SYSTEM, IS PERMITTED WITHOUT THE WRITTEN PERMISSION OF GODFREY & HOFFMAN HODGE, LLC. THE INFORMATION CONTAINED HEREIN IS PROVIDED AS IS, WITHOUT WARRANTY OF ANY KIND, INCLUDING MERCHANTABILITY. © COPYRIGHT 2020. ALL RIGHTS RESERVED.

NO.	DATE	REVISION SCHEDULE	DESCRIPTION

PROJECT:  
**BLUE NINE TREE MANAGEMENT**  
 160 COUNTRY CLUB ROAD  
 AVON, CT

PREPARED FOR:  
**GOLF CLUB OF AVON**  
 160 COUNTRY CLUB ROAD  
 AVON, CT

**TREE MANAGEMENT PLAN**  
 DRAWN BY: JR  
 CHECKED BY: JR  
 SCALE: 1"=60'  
 PROJECT: 21-001  
 DATE: 02.10.2021

**C-3.0**



MATCH LINE C-3.0

REFER TO DRAWING NO. C-7.0 FOR EROSION AND SEDIMENTATION CONTROL DETAILS AND NOTES.



MATCH LINE C-4.0

MATCH LINE C-6.0

**GODFREY & HOFFMAN**  
**HODGE, LLC**  
 PROFESSIONAL ENGINEERS  
 26 BROADWAY NORTH HAVEN, CT 06473 TEL: 203.239.4371 WWW.GODFREYHOFFMAN.COM  
 1783 FARMINGTON AVENUE, UNIONVILLE, CT 06886 TEL: 860.673.0444 WWW.HODGELL.COM

**FOR REVIEW ONLY**  
 NOT VALID WITHOUT THE SIGNATURE AND SEAL

ALL WORK, MATERIALS, AND METHODS TO BE IN ACCORDANCE WITH THE LATEST EDITIONS OF THE SPECIFICATIONS FOR CONSTRUCTION OF PUBLIC WORKS OF THE STATE OF CONNECTICUT. THE WORD "SHALL" OR "SHOULD" IS UNDERSTOOD TO BE MANDATORY UNLESS OTHERWISE INDICATED. THE WORD "MAY" IS UNDERSTOOD TO BE PERMISSIVE UNLESS OTHERWISE INDICATED. THE INFORMATION CONTAINED HEREIN IS THE PROPRIETARY AND CONFIDENTIAL INFORMATION OF GODFREY & HOFFMAN HODGE, LLC. NO PART OF THIS DOCUMENT IS TO BE REPRODUCED OR TRANSMITTED IN ANY FORM OR BY ANY MEANS, ELECTRONIC OR MECHANICAL, INCLUDING PHOTOCOPYING, RECORDING, OR BY ANY INFORMATION STORAGE AND RETRIEVAL SYSTEM, WITHOUT THE WRITTEN PERMISSION OF GODFREY & HOFFMAN HODGE, LLC. © COPYRIGHT 2020. ALL RIGHTS RESERVED.

NO.	DATE	DESCRIPTION

PROJECT:  
**BLUE NINE TREE MANAGEMENT**  
 160 COUNTRY CLUB ROAD AVON, CT

PREPARED FOR:  
**GOLF CLUB OF AVON**  
 160 COUNTRY CLUB ROAD AVON, CT

**TREE MANAGEMENT PLAN**  
 DRAWN BY: JR  
 CHECKED BY: JR  
 SCALE: 1"=60'  
 PROJECT: 21-001  
 DATE: 02.10.2021

**C-5.0**

IMPORTANT NOTE:  
 ADDITIONAL UNDERGROUND UTILITIES MAY EXIST. PRIOR TO ANY EXCAVATION OR CONSTRUCTION, CONTACT:  
 "CALL BEFORE YOU DIG" 1-800-922-4455

REFER TO DRAWING NO. C-7.0 FOR EROSION AND SEDIMENTATION CONTROL DETAILS AND NOTES.

MATCH LINE C-5.0

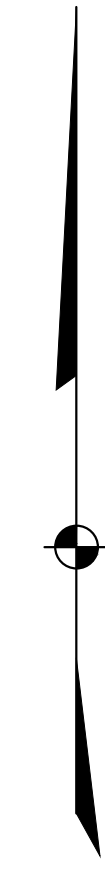

**IMPORTANT NOTE:**  
 ADDITIONAL UNDERGROUND UTILITIES MAY EXIST.  
 PRIOR TO ANY EXCAVATION OR CONSTRUCTION,  
 CONTACT:  
 "CALL BEFORE YOU DIG" 1-800-922-4455

**FOR REVIEW ONLY**  
NOT VALID WITHOUT THE SIGNATURE AND SEAL

ALL WORK, MATERIALS, AND METHODS TO BE IN STRICT ACCORDANCE WITH THE LATEST EDITIONS OF THE SPECIFICATIONS AND STANDARDS OF THE PROFESSION OF LANDSCAPE ARCHITECTURE. THE USER OF THIS DOCUMENT IS UNDERSTOOD TO BE RESPONSIBLE FOR OBTAINING ALL NECESSARY PERMITS AND APPROVALS FROM THE APPROPRIATE AGENCIES AND AUTHORITIES. THE INFORMATION CONTAINED HEREIN IS THE PROPRIETARY AND CONFIDENTIAL INFORMATION OF GODFREY & HOFFMAN HODGE, LLC. NO PART OF THIS DOCUMENT IS TO BE REPRODUCED, COPIED, OR TRANSMITTED IN ANY FORM OR BY ANY MEANS, ELECTRONIC OR MECHANICAL, INCLUDING PHOTOCOPYING, RECORDING, OR BY ANY INFORMATION STORAGE AND RETRIEVAL SYSTEM, WITHOUT THE WRITTEN PERMISSION OF GODFREY & HOFFMAN HODGE, LLC. © COPYRIGHT 2020. ALL RIGHTS RESERVED.

REVISION SCHEDULE	
NO.	DESCRIPTION

**PROJECT:**  
**BLUE NINE TREE MANAGEMENT**  
 160 COUNTRY CLUB ROAD  
 AVON, CT

**PREPARED FOR:**  
**GOLF CLUB OF AVON**  
 160 COUNTRY CLUB ROAD  
 AVON, CT

**TREE MANAGEMENT PLAN**

**DRAWN BY:** JJR  
**CHECKED BY:** JJR  
**SCALE:** 1"=60'  
**PROJECT:** 21-001  
**DATE:** 02.10.2021

**C-6.0**

**GODFREY & HOFFMAN HODGE, LLC**  
 PROFESSIONAL LANDSCAPE ARCHITECTS  
 26 BROADWAY NORTH AVENUE, SUITE 207  
 1783 FARMINGTON AVENUE, UNIONVILLE, CT 06885  
 TEL: 860.673.0444 - WWW.HODGELL.COM

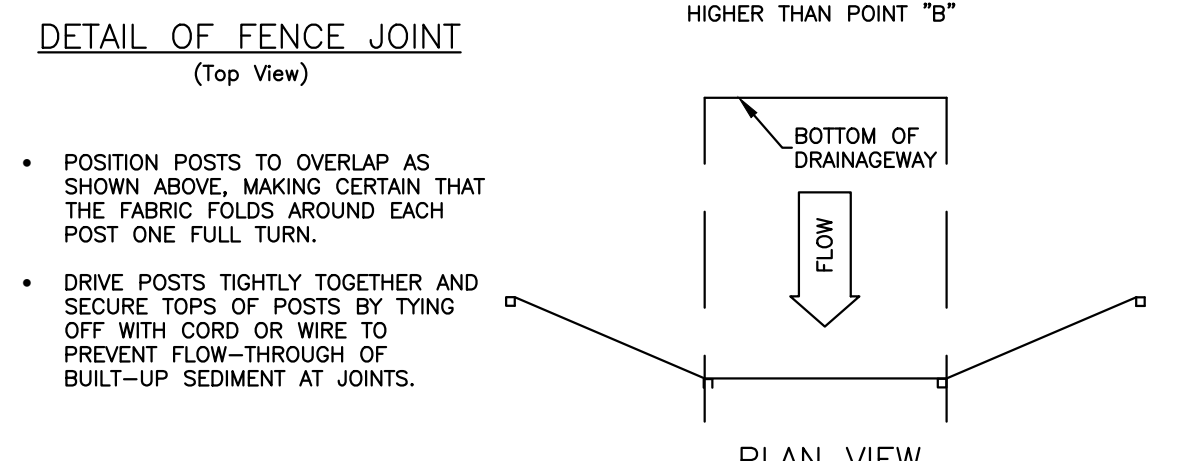
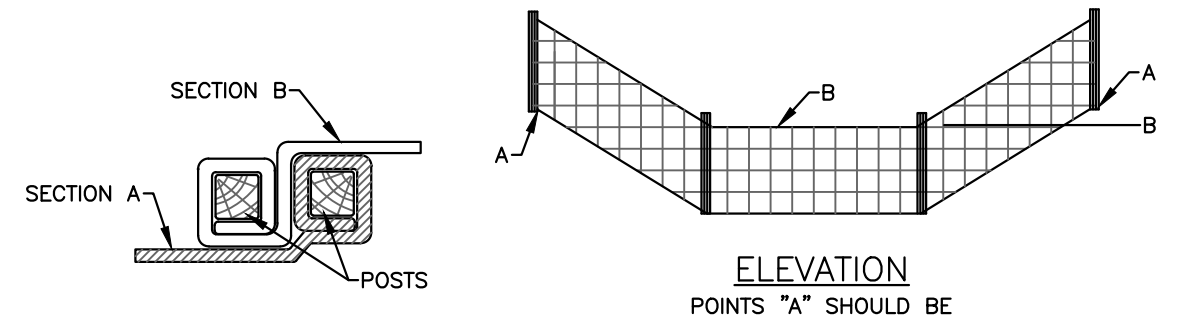
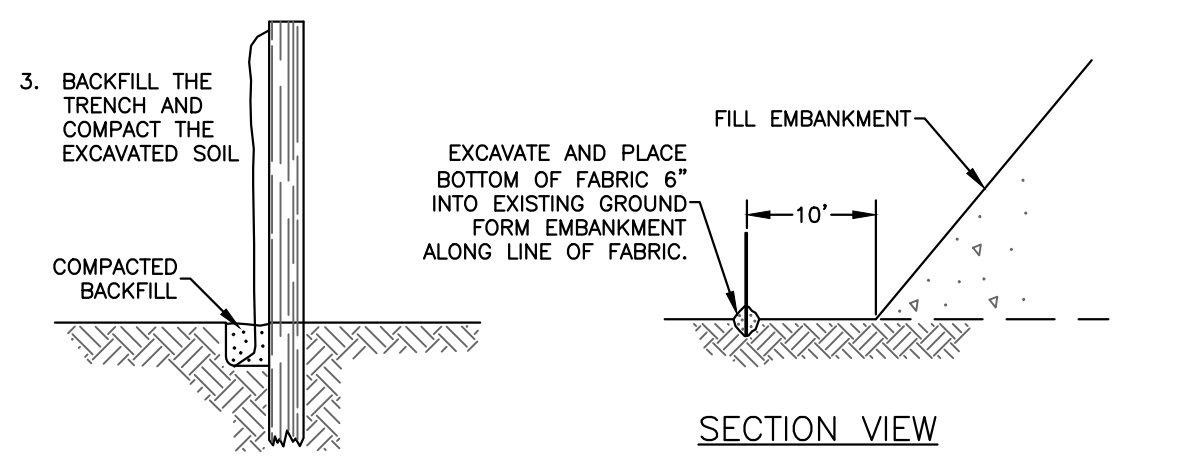
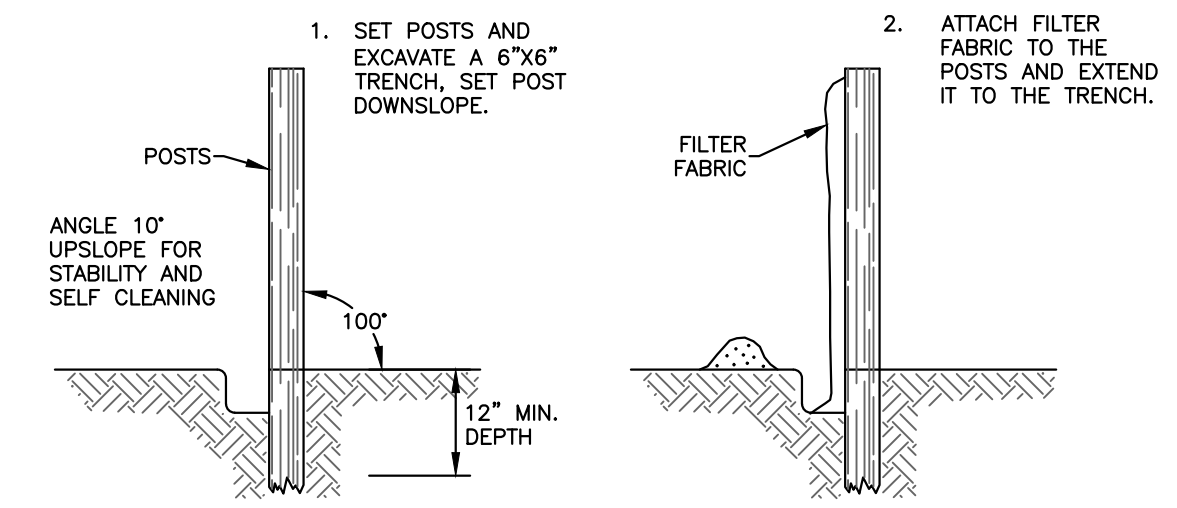

**SILT FENCE NOTES:**

**MATERIALS:**  
 GEOTEXTILE FABRIC: GEOTEXTILE FABRIC SHALL BE A PERVIOUS SHEET OF POLYPROPYLENE NYLON, POLYESTER, ETHYLENE OR SIMILAR FILAMENTS AND SHALL CONFORM TO THE FOLLOWING REQUIREMENTS:

PHYSICAL PROPERTY	TEST METHOD	MINIMUM REQUIREMENT
FILTERING EFFICIENCY	ASTM 5141	75% (MINIMUM)
GRAB TENSILE STRENGTH	ASTM D4632	100 LBS.
ELONGATION @ FAILURE	ASTM D4632	75%
MULLEN BURST STRENGTH	ASTM D3786	250 PSI
PUNCTURE STRENGTH	ASTM 4833	50 LBS.
APPARENT OPENING SIZE	ASTM D4751	NO LESS THAN 0.90 MM AND NO GREATER THAN 0.60 MM
FLOW RATE	ASTM D4491	0.2 GAL/FT <sup>2</sup> /MIN.
PERMATIVITY	ASTM D4491	0.05 SEC. -1 (MIN.)
ULTRAVIOLET RADIATION STABILITY %	ASTM D4355	70% AFTER 500 HOURS OF EXPOSURE (MIN.)

**SUPPORTING POSTS:**  
 POSTS SHALL BE AT LEAST 42" LONG MADE OF EITHER 1.5 INCH SQUARE HARDWOOD STAKES OR SHALL BE POSTS WITH PROTECTORS FOR FASTENING THE GEOTEXTILE POSSESSING A MINIMUM STRENGTH OF 0.5 POUNDS PER LINEAR FOOT.

**INSTALLATION:**  
 TRENCH EXCAVATION: EXCAVATE A TRENCH 6 INCHES DEEP AND 6 INCHES WIDE ON THE UPHILL SIDE OF THE FENCE LOCATION. FOR SLOPE AND SWALE INSTALLATIONS, EXTEND THE ENDS OF THE TRENCH UPHILL SO THAT THE BOTTOM END OF THE FENCE WILL BE HIGHER THAN THE TOP OF THE LOWEST PORTION OF THE FENCE.

**SUPPORT POSTS:**  
 INSTALL SUPPORT POSTS ON THE DOWNHILL SIDE OF THE TRENCH TO A MINIMUM DEPTH OF 12 INCHES TO ORIGINAL GROUND. SUPPORT POSTS SHALL BE SPACED NO GREATER THAN 10 FEET APART. SUPPORT POSTS SHOULD BE INSTALLED CLOSER THAN 10 FEET ON STEEP SLOPES OR WHEN CONCENTRATED FLOWS ARE ANTICIPATED.

**GEOTEXTILE FILTER FABRIC:**  
 STAPLE OR SECURE THE GEOTEXTILE TO THE SUPPORT POSTS PER MANUFACTURER'S INSTRUCTION SUCH THAT AT LEAST 6 INCHES OF GEOTEXTILE LIES WITHIN THE TRENCH. THE HEIGHT OF THE FENCE SHALL NOT EXCEED 30 INCHES.

**BACKFILL & COMPACTION:**  
 BACKFILL TRENCH WITH TAMPED SOIL OR AGGREGATE OVER THE GEOTEXTILE.

**MAINTENANCE:**

SILT FENCE SHOULD BE INSPECTED AT LEAST ONCE A WEEK AND WITHIN 24 HOURS OF THE END OF A STORM WITH A RAINFALL AMOUNT OF 0.5 INCHES OR GREATER. SEDIMENT DEPOSITS ARE TO BE REMOVED. FENCE SHOULD BE REPAIRED OR REPLACES WITHIN 24 HOURS OF OBSERVED FAILURE.

### GEOTEXTILE SILT FENCE (GSF):

NOT TO SCALE

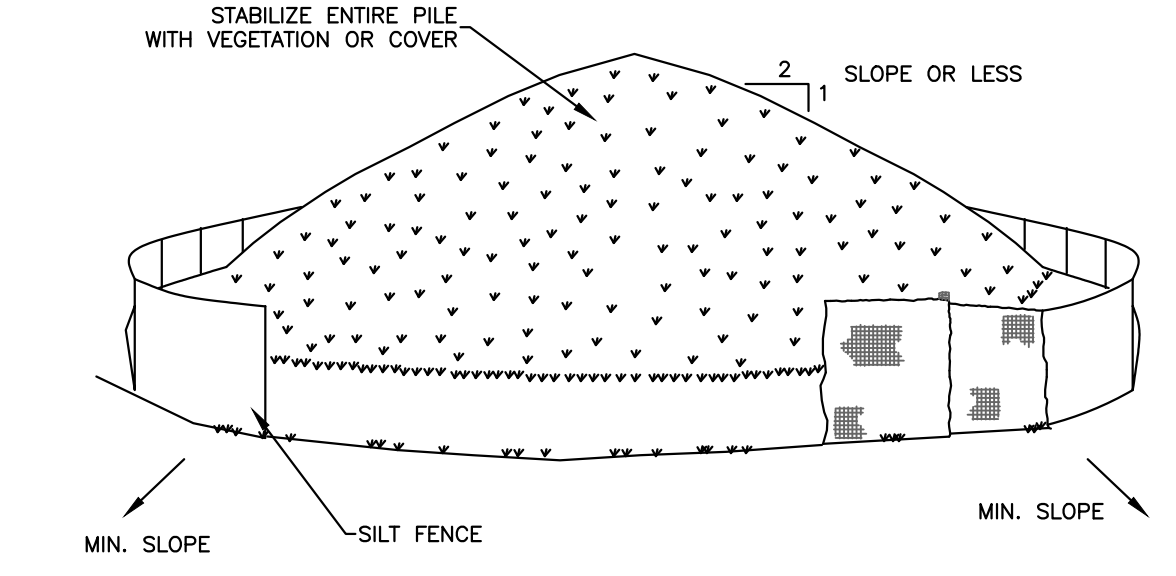

**INSTALLATION NOTES:**

- AREA CHOSEN FOR STOCKPILING OPERATIONS SHALL BE DRY AND STABLE.
- MAXIMUM SLOPE OF STOCKPILE SHALL BE 2 HORIZONTAL TO 1 VERTICAL.
- UPON COMPLETION OF SOIL STOCKPILING, EACH PILE SHALL BE SURROUNDED WITH EITHER SILT FENCING OR STRAWBALES, THEN STABILIZED WITH VEGETATION OR COVERED.

### SOIL STOCKPILING

NOT TO SCALE

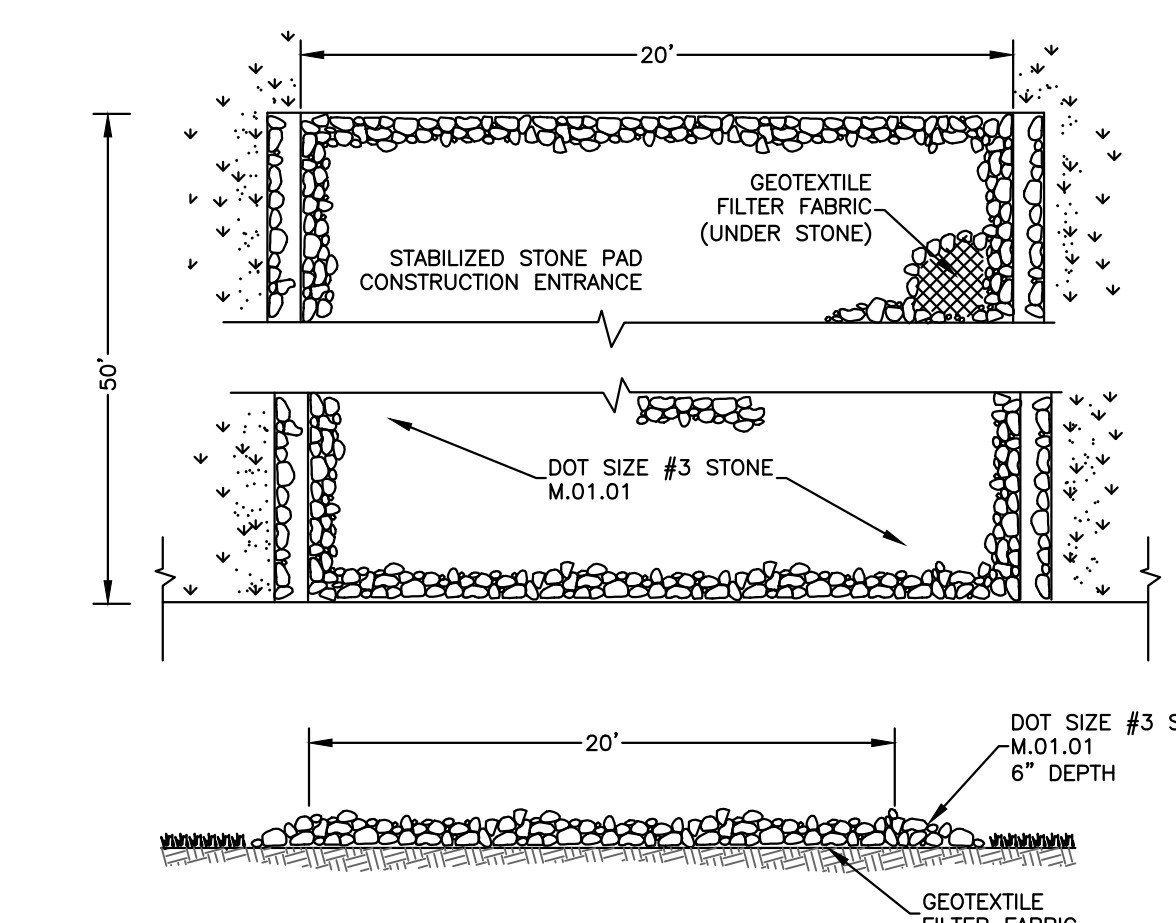

**CONSTRUCTION ENTRANCE NOTES:**

- MATERIALS**
  - STONE: USE ANGULAR STONE SIZED ACCORDING TO THE STANDARDS SET BY ASTM C-33, SIZE NO. 2 OR 3, OR DOT STANDARD SPECIFICATIONS SECTION M.O.1.01, SIZE #3.
  - GEOTEXTILE: FIBERS USED IN THE GEOTEXTILE SHALL CONSIST OF SYNTHETIC POLYMERS COMPOSED OF AT LEAST 85% BY WEIGHT POLYPROPYLENES, POLYESTERS, AND POLYAMIDES, POLYETHYLENE, POLYOLEFINS, OR POLYVINYLIDENE-CHLORIDES. THE FIBERS SHALL BE FORMED IN A STABLE NETWORK OF FILAMENTS OR YARNS RETAINING DIMENSIONAL STABILITY RELATIVE TO EACH OTHER. THE GEOTEXTILE USED SHALL BE SPECIFICALLY INTENDED FOR "ROAD STABILIZATION" APPLICATIONS AND SHALL BE CONSISTENT WITH THE MANUFACTURER'S RECOMMENDATIONS FOR THE INTENDED USE.
- DIMENSIONS SHALL BE AS INDICATED ON THE DETAIL.**
- CONSTRUCTION:** CLEAR THE AREA OF THE ENTRANCE OF ALL VEGETATION, ROOTS, AND OTHER OBJECTIONABLE MATERIAL. AT POORLY DRAINED LOCATIONS INSTALL SUBSURFACE DRAINAGE INSURING THE OUTLETS TO THE DRAINS ARE FREE-FLOWING. IF USING GEOTEXTILE IN PLACE OF A FREE DRAINING MATERIAL, UNROLL THE GEOTEXTILE IN A DIRECTION PARALLEL TO THE ROADWAY CENTERLINE IN A LOOSE MANNER PERMITTING IT TO CONFORM TO THE SURFACE IRREGULARITIES WHEN THE STONE IS PLACED. THE GEOTEXTILE MAY BE TEMPORARILY SECURED WITH PINS RECOMMENDED OR PROVIDED BY THE MANUFACTURER BUT THEY SHALL BE REMOVED PRIOR TO PLACEMENT OF THE STONE. PLACE THE STONE TO THE SPECIFIED DIMENSIONS. KEEP ADDITIONAL STONE AVAILABLE OR STOCKPILE OF FUTURE USE.
- MAINTENANCE:** MAINTAIN THE ENTRANCE IN A CONDITION WHICH WILL PREVENT TRACKING AND WASHING OF THE SEDIMENT ONTO PAVED SURFACES. PROVIDE PERIODIC TOP DRESSING WITH ADDITIONAL STONE OR ADDITIONAL LENGTH AS CONDITIONS DEMAND. ROADS ADJACENT TO THE CONSTRUCTION SITE SHALL BE LEFT CLEAN AT THE END OF EACH DAY. IF THE CONSTRUCTION ENTRANCE IS BEING PROPERLY MAINTAINED AND THE ACTION OF A VEHICLE TRAVELING OVER THE STONE PAD IS NOT SUFFICIENT TO REMOVE THE MAJORITY OF THE SEDIMENT, THEN EITHER (1) INCREASE THE LENGTH OF THE CONSTRUCTION ENTRANCE, OR (2) MODIFY THE CONSTRUCTION ACCESS ROAD SURFACE, OR (3) INSTALL WASHING RACKS AND ASSOCIATED SETTLING AREA OR SIMILAR DEVICES BEFORE THE VEHICLE ENTERS PAVED SURFACES.

### CONSTRUCTION ENTRANCE

NOT TO SCALE

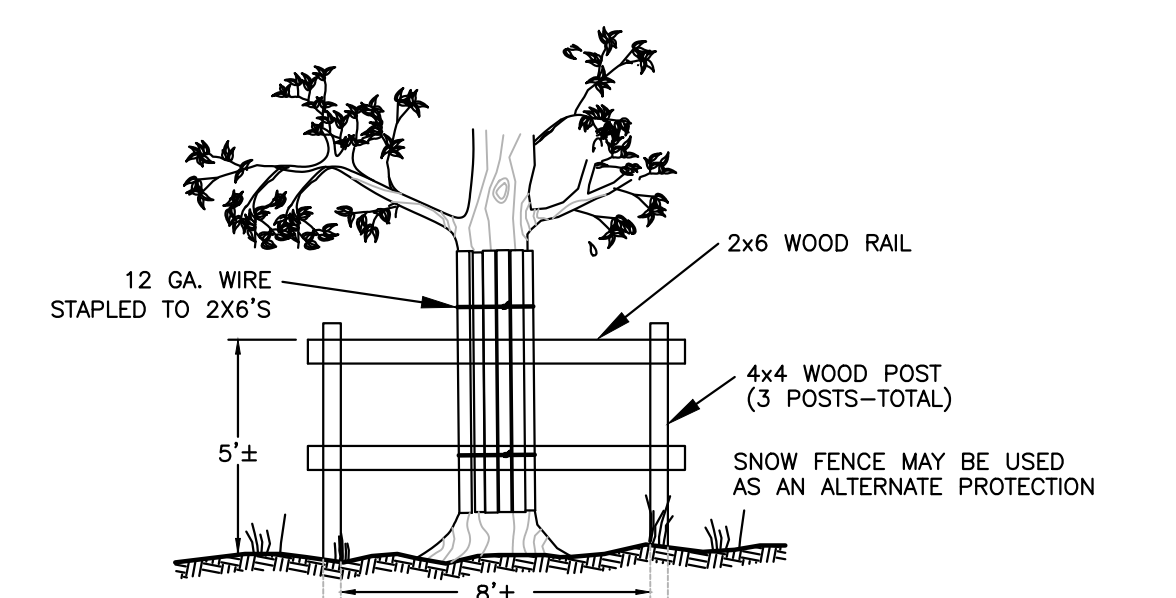

### EXISTING TREE PROTECTION DETAIL

NOT TO SCALE

### GENERAL NOTES:

- HAYBALE FILTERS OR SILTATION FENCE WILL BE INSTALLED AT ALL CULVERT OUTLETS AND ALONG THE TOE OF ALL CRITICAL CUT AND FILL SLOPES.
- CATCH BASINS WILL BE PROTECTED WITH HAYBALE FILTERS OR SILTATION FENCE THROUGHOUT THE CONSTRUCTION PERIOD AND UNTIL ALL DISTURBED AREAS ARE THOROUGHLY STABILIZED.
- ALL EROSION AND SEDIMENTATION CONTROL MEASURES WILL BE CONSTRUCTED IN ACCORDANCE WITH THE STANDARDS AND SPECIFICATIONS OF THE CONNECTICUT EROSION & SEDIMENT CONTROL HANDBOOK.
- EROSION AND SEDIMENT CONTROL MEASURES WILL BE INSTALLED PRIOR TO CONSTRUCTION WHENEVER POSSIBLE.
- ALL CONTROL MEASURES WILL BE MAINTAINED IN EFFECTIVE CONDITION THROUGHOUT THE CONSTRUCTION PERIOD.
- ADDITIONAL CONTROL MEASURES WILL BE INSTALLED DURING THE CONSTRUCTION PERIOD, IF NECESSARY OR REQUIRED.
- SEDIMENT REMOVED FROM CONTROL STRUCTURES WILL BE DISPOSED OF IN A MANNER WHICH IS CONSISTENT WITH THE INTENT OF THE PLAN.
- CONTRACTOR IS ASSIGNED THE RESPONSIBILITY FOR IMPLEMENTING THIS EROSION AND SEDIMENT CONTROL PLAN. THIS RESPONSIBILITY INCLUDES THE INSTALLATION AND MAINTENANCE OF CONTROL MEASURES, INFORMING ALL PARTIES ENGAGED ON THE CONSTRUCTION SITE OF THE REQUIREMENTS AND OBJECTIVES OF THE PLAN, NOTIFYING THE CITY LAND USE OFFICE OF ANY TRANSFER OF THIS RESPONSIBILITY, AND FOR CONVEYING A COPY OF THE EROSION AND SEDIMENT CONTROL PLAN IF THE TITLE TO THE LAND IS TRANSFERRED.
- AFFECTED PORTIONS OF OFF-SITE ROADS MUST BE SWEEP CLEAN WHEN REQUIRED OR AT LEAST ONCE A WEEK DURING CONSTRUCTION. DUST CONTROL TO BE ACHIEVED WITH COVERING TRUCK LOADS, SWEEPING ROADS, WATERING AS REQUIRED, OR AS ORDERED BY THE SITE ENGINEER.
- BRUSH SHALL BE CHIPPED AND REMOVED FROM SITE. TRANSPORT STUMPS OFF-SITE. DO NOT BURY TOPSOIL FROM DISTURBED AREAS SHALL BE STRIPPED AND STOCKPILED FOR USE IN FINAL LANDSCAPING.
- AFTER EACH STORM EVENT OR ONCE WEEKLY, ALL SEDIMENT AND EROSION CONTROLS WILL BE INSPECTED. ANY CORRECTIVE ACTIONS TO MITIGATE ENVIRONMENTAL CONCERNS WILL BE ORDERED BY THE SITE ENGINEER OR SITE E&S CONTROL MONITOR.
- ALL PERMANENT AND TEMPORARY SEDIMENT CONTROL DEVICES WILL BE MAINTAINED IN EFFECTIVE CONDITION UNTIL ALL UPLAND AREAS ARE FULLY STABILIZED. UPON COMPLETION OF WORK, ALL TEMPORARY SEDIMENT CONTROL DEVICES SUCH AS SILT FENCE AND HAYBALES SHOULD BE REMOVED FROM THE SITE AND SEDIMENT REMOVED FROM ALL ON-SITE CATCH BASINS AND DISPOSED OF LEGALLY.
- NO CONSTRUCTION OR CONSTRUCTION EQUIPMENT WILL BE ALLOWED ON THE DOWNHILL SIDE OF THE SILT FENCE AS SHOWN ON PLANS, EXCEPT DURING CONSTRUCTION OF ANY ITEMS SHOWN DOWNHILL OF SILT FENCE.

### TOPSOIL (TO)

**MATERIALS:**  
 TOPSOIL SHALL INCLUSIVELY MEAN A SOIL:  
 MEETING ONE OF THE FOLLOWING SOIL TEXTURES CLASSIFIED ESTABLISHED BY THE USDA CLASSIFICATION SYSTEM BASED UPON THE PROPORTION OF SAND, SILT AND CLAY SIZE PARTICLES AFTER PASSING A 2 MM SIEVE AND SUBJECT TO A PARTICLE SIZE ANALYSIS:  
 LOAMY SAND, INCLUDING COARSE, LOAMY FINE, AND LOAMY VERY FINE SAND, SANDY LOAM, INCLUDING COARSE, FINE AND VERY FINE SANDY LOAM, LOAM, OR SILT LOAM WITH NOT MORE THAN 60% SILT; CONTAINING NOT LESS THAN 6% AND NOT MORE THAN 20% ORGANIC MATTER AS DETERMINED BY LOSS-ON-IGNITION OF OVEN DRIED SAMPLES DRIED AT 105 DEGREES CENTIGRADE; POSSESSING A PH RANGE OF 6.0-7.5, EXCEPT IF THE VEGETATIVE PRACTICE BEING USED SPECIFICALLY REQUIRES A LOWER PH, THEN THE PH MAY BE ADJUSTED ACCORDINGLY; HAVING SOLUBLE SALTS NOT EXCEEDING 500 PPM, AND THAT IS LOOSE AND FRABLE AND FREE FROM REFUSE, STUMPS, ROOTS, BRUSH, WEEDS, FROZEN PARTICLES, ROCKS AND STONES OVER 1 X" IN DIAMETER, AND ANY MATERIAL THAT WILL PREVENT THE FORMATION OF A SUITABLE SEEDBED AND PREVENT SEED GERMINATION AND PLANT GROWTH. TOPSOIL MAY OF NATURAL ORIGIN OR MANUFACTURED BY BLENDING COMPOSTED ORGANIC MATERIALS WITH ORGANIC DEFICIENT SOILS, MINERAL SOILS, SAND AND LIME SUCH THAT THE RESULTING SOIL MEETS THE MATERIAL SPECIFICATIONS ABOVE.

### OPERATION & MAINTENANCE OF EROSION AND SEDIMENTATION CONTROL MEASURES

- SILTATION FENCE**
  - ALL SILTATION FENCES SHALL BE INSPECTED AFTER EACH RAINFALL. ALL DETERIORATED FABRIC AND DAMAGED POSTS SHALL BE REPLACED AND PROPERLY REPOSITIONED IN ACCORDANCE WITH THIS PLAN.
  - SEDIMENT DEPOSITS SHALL BE REMOVED FROM BEHIND THE FENCE WHEN THEY EXCEED A HEIGHT OF ONE FOOT.
- HAYBALES**
  - ALL HAYBALE RINGS SHALL BE INSPECTED FOLLOWING EACH RAINFALL. REPAIR OR REPLACEMENT SHALL BE PROMPTLY MADE AS NEEDED.
  - DEPOSITS SHALL BE REMOVED AND CLEANED-OUT IF ONE HALF OF THE ORIGINAL HEIGHT OF THE BALES BECOMES FILLED WITH SEDIMENT.

### CONTINGENCY EROSION PLAN:

SHOULD UNFORESEEN EROSION OR SEDIMENTATION PROBLEMS ARISE, THE DESIGN ENGINEER OF RECORD AND LOCAL ENFORCEMENT AGENT SHALL BE NOTIFIED IMMEDIATELY. AN INSPECTION OF THE AFFECTED AREA(S) SHALL BE PROMPTLY PERFORMED. A REMEDIAL ACTION PLAN SHALL BE FORMULATED WITH THE LOCAL ENFORCEMENT AGENT'S APPROVAL. THE SITE CONTRACTOR SHALL THEN IMPLEMENT THE RECOMMENDED COURSE OF ACTION WHICH HAS BEEN DETERMINED BY BOTH THE ENGINEER AND LOCAL ENFORCEMENT AGENT.

### DUST CONTROL:

- THE CONTRACTOR SHALL PROVIDE DUST CONTROL THROUGHOUT THE PROJECT UNTIL SUCH TIME AS ALL DISTURBED AREAS HAVE BEEN STABILIZED. THE CONTRACTOR SHALL UTILIZE METHODS ACCEPTABLE TO THE TOWN ENVIRONMENTAL ENFORCEMENT OFFICER. THE FOLLOW OPERATIONS SHALL BE PERFORMED AS A MINIMUM:
- PERIODICALLY MOISTEN EXPOSED SOIL AREAS WITH WATER ON UNPAVED SURFACES.
  - USE OF MECHANICAL SWEEPING ON PAVED AREAS WHERE DUST AND FINE MATERIALS ACCUMULATE AS A RESULT OF TRUCK TRAFFIC, PAVEMENT SAW CUTTING SPILLAGE, AND WIND OR WATER DEPOSITION FROM ADJACENT DISTURBED AREAS. SWEEP DAILY IN HEAVILY TRAFFICKED AREAS OR AS WARRANTED.
  - REPEAT APPLICATION OF DUST CONTROL MEASURES WHEN DUST CONDITIONS BECOME EVIDENT.

**GODFREY & HOFFMAN**  
**HODGE, LLC**  
 PROFESSIONAL LAND SURVEYORS & CIVIL ENGINEERS  
 58 BROADWAY, SUITE 200, WESTPORT, CONNECTICUT 06880  
 1785 FARMINGTON AVENUE, UNIONVILLE, CT 06086 | TEL: 860.674.1444 | WWW.HODGEHILL.COM

**FOR REVIEW ONLY**

ALL WORK, LABOR, AND MATERIALS TO BE IN STRICT ACCORDANCE WITH THE SPECIFICATIONS AND STANDARDS OF THE CONNECTICUT DEPARTMENT OF TRANSPORTATION AND THE CITY OF WESTPORT. THE CONTRACTOR SHALL BE RESPONSIBLE FOR OBTAINING ALL NECESSARY PERMITS AND APPROVALS FROM THE CITY OF WESTPORT AND THE STATE OF CONNECTICUT. THE CONTRACTOR SHALL BE RESPONSIBLE FOR OBTAINING ALL NECESSARY PERMITS AND APPROVALS FROM THE CITY OF WESTPORT AND THE STATE OF CONNECTICUT. THE CONTRACTOR SHALL BE RESPONSIBLE FOR OBTAINING ALL NECESSARY PERMITS AND APPROVALS FROM THE CITY OF WESTPORT AND THE STATE OF CONNECTICUT.

NO.	DATE	REVISION	SCHEDULE	DESCRIPTION

**PROJECT:**  
**BLUE NINE TREE MANAGEMENT**  
 160 COUNTRY CLUB ROAD  
 AVON, CT

**PREPARED FOR:**  
**GOLF CLUB OF AVON**  
 160 COUNTRY CLUB ROAD  
 AVON, CT

**EROSION & SEDIMENTATION CONTROL DETAILS & NOTES**

DRAWN BY: JR  
 CHECKED BY: JR  
 SCALE: NTS  
 PROJECT: 21-001  
 DATE: 02.10.2021

**C-7.0**